

FireCrunch Party Wall - Single 19mm Sheet
Install using 19mm K-Fire TG SL4
4 sided TG, eliminates butt joints
Sheet Size 2700 x 600mm

K-FIRE 19 SL4 SHAFT LINER SYSTEM

Party Wall: Systems are designed to provide a separating fire wall and acoustic Rw50 construction between adjacent buildings or tenancies in Class 1 to Class 10 buildings.

NATA Labs Australia Fire Tested Systems AS1530.4/2014-2029
CSIRO and more

Acoustic Rw62 + Ctr = 52
FRL .../60/60 (timber frame) non load bearing
FRL 90/90/90 (steel frame) load bearing



FIRE PROOF



FLOOD PROOF



IMPACT RESISTANT



TERMITE PROOF



MOULD & BACTERIA PROOF



FIRECRUNCH K-FIRE 19 SL4 SHAFT LINER FIRE PARTY WALL (4-sided TG)

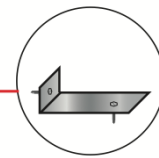
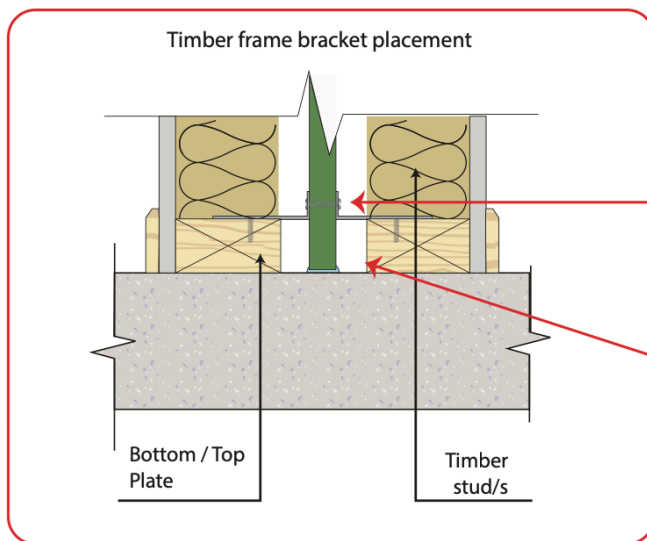
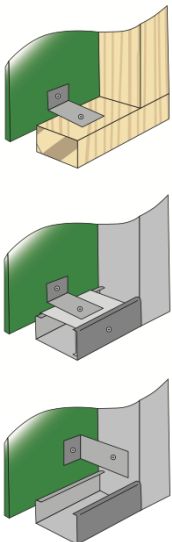
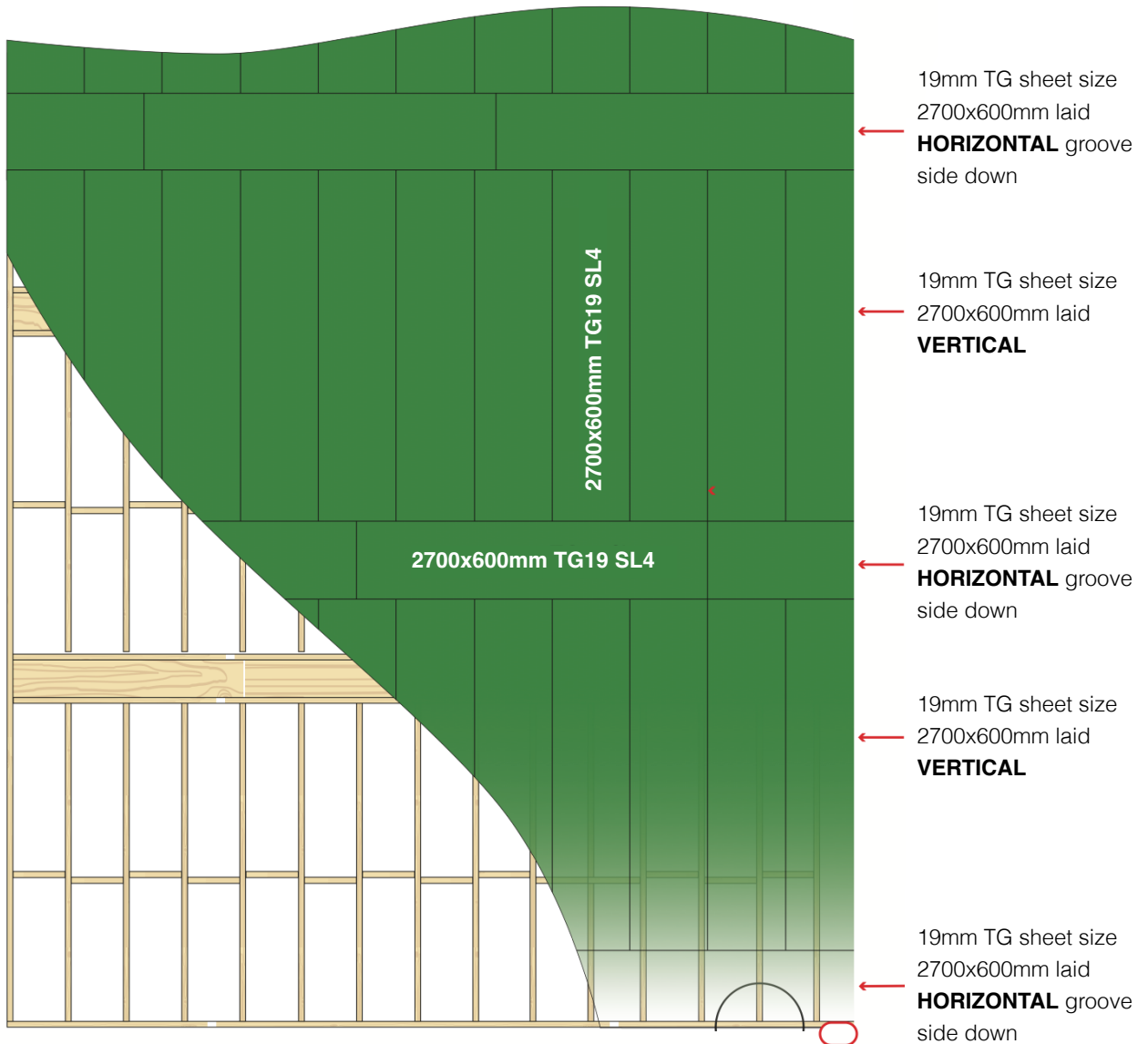

Aluminium Stud Bracket size 45x75mm 1.60 BMT

Bottom Plate



NEW FIRECRUNCH SHAFT LINER K-FIRE 19 SL4 (4-sided TG)

LESS TIME, MONEY, MATERIALS AND INCREASES THE ROI

FireCrunch K-Fire 19 SL4 Shaft Liner FRL 90/90/90 to 120/120/120 is a fast easy and lightweight discontinuous fire wall. RW52 net Ctr acoustic fire wall system for applications in party walls, common walls, fire separation walls between townhouses, units and apartments.

Unlike other party wall systems, the **FireCrunch Shaft Liner has only three components.**

FireCrunch SL4 is a non organic composite cladding, no tree destruction for plasterboard paper linings. Replaces heavily CO2 pollutive Fyrchek plasterboard and **at a lower price.**

It is impervious to weather, rain, etc. until roof cover is on and won't degrade in water at all unlike plasterboard.

Compares directly with CSR, Boral and Hebel fire walls at a far better rate while using a high carbon capture tree-friendly cladding and 19mm shaft liner product, MgSO4, and not heavy CO2 pollutive 25mm Fyrchek or similar.

FireCrunch helps meet good citizen, new federal Government guidelines for 2030 in diversion to low CO2 products.

NO SPECIAL EXPENSIVE SUPPORT EQUIPMENT

NATA Labs tested products

AS1530.1, AS1530.4, AS3837, AS5637, AS717.1, AS4964

- ★ No cranes
- ★ No gantries
- ★ No H stud joiners
- ★ No U track
- ★ No extra hard to fix 16mm Fyrchek fire protection overlap at floor and truss junctions
- ★ No special cementitious glues or compounds
- ★ Our unique self-fitting 4-sided TG board fixes in half the time

Lock the system in place with our special **SL19 aluminium brackets, which FireCrunch supplies** for the correct placement of the boards. The fast set TG fire joints are gun-in sealed with standard AS1530.4 fire rated sealant using regular off-the-shelf screws which are all **available from your local trades supplier.**

FireCrunch K-Fire 19 Shaft Liner is a lightweight, fast-to-install, easy to understand system which will **save** you time, resources, on-site labour and most importantly, **money.** See *Cost Comparison* below.

The K-19 system will improve your time management on-site and improve your bottom line.

FireCrunch is fully tested by NATA certified labs in Australia and approved for use in all party wall fire applications. And, it is acoustic Rw52 net of Ctr to FRL 60, 90 and 120 minutes.

FireCrunch is a registered business name owned by X-Fire International P/L and licensed to FireCrunch Australasia P/L ABN 37 620 875 041 - an ASIC registered Australian Corporation

NEW!

K-FIRE 19 SL 4-SIDED TG LOAD BEARING SHAFT LINER FIRE SEPARATION WALL FRL .../90/90 Using Low Cost 10mm Plasterboard Sheets

COST BENEFITS

K-Fire 19 NATA Labs tested for FRL .../90/90 in Timber or Steel. Also use this K-Fire 19 system for two and three level townhouses, semi-detached or cluster housing construction. K-Fire does NOT require any expensive 16mm Fyrchek plasterboard patches at each floor or truss junction. K-Fire requires no H-studs, J-track or side track and is fully supported by the unique 4-sided 19mm SL TG sheets, some 35% under market price. Overall, cuts assembly time by 50%, eliminates square butt end joints with FireCrunch SL4 unique 4-sided TG sheets 2700x600mm. No extra fire blocking and sealing and no weak overlap fire joints like other offerings (FireCrunch since 2015).

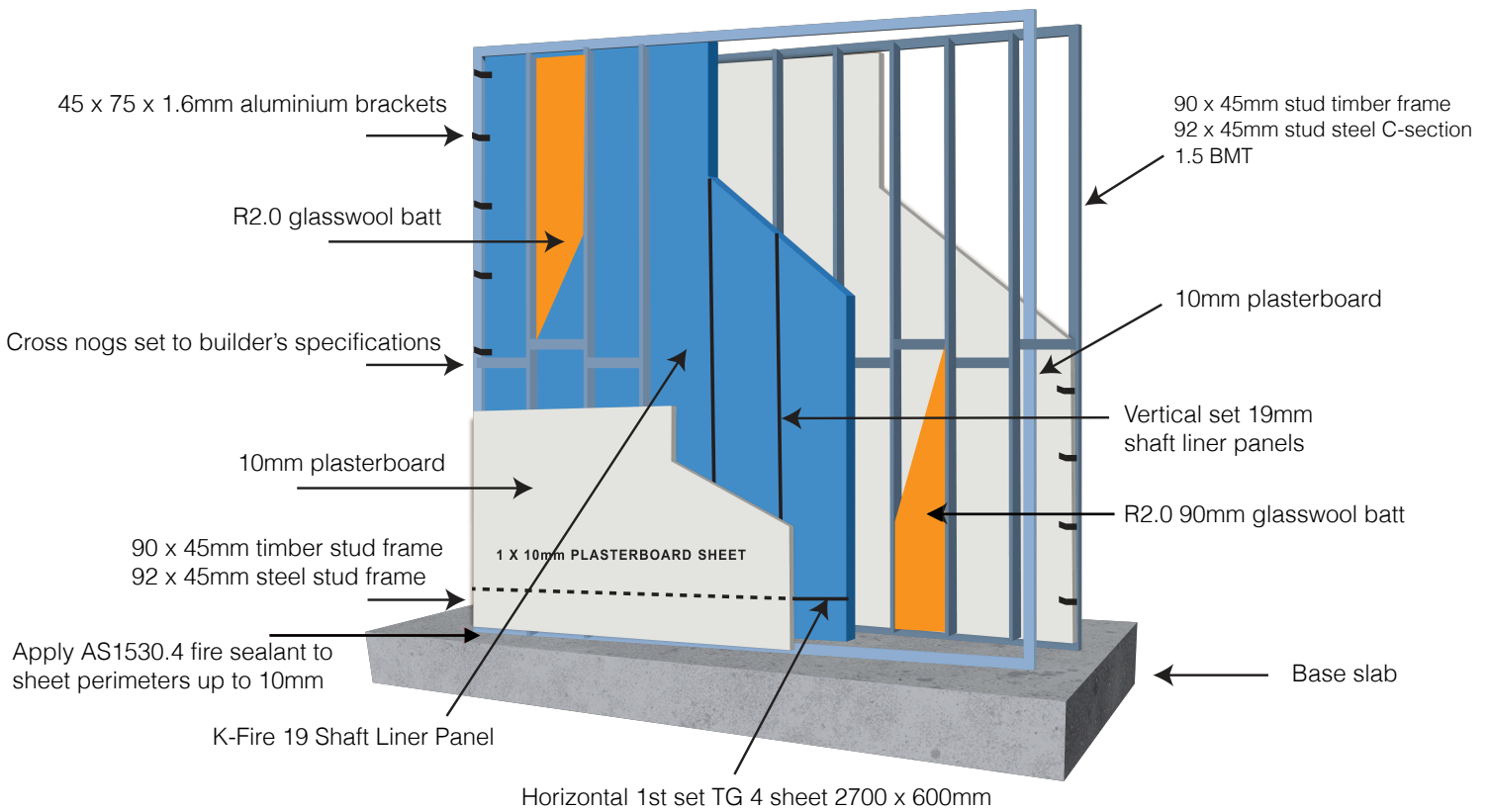

TIMBER OR STEEL FRAME BRACKET PLACEMENT

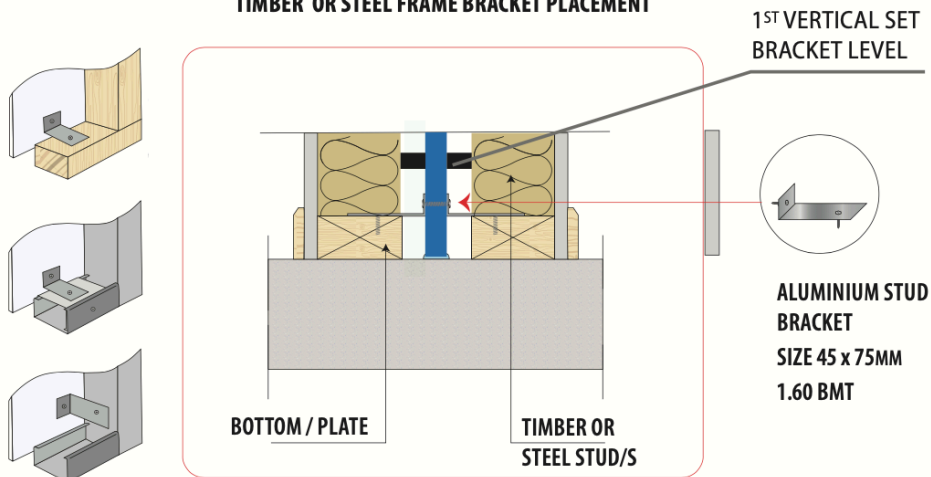

Cost Comparison 2025 - Fact Sheet FCA

FIRECRUNCH SHAFT LINER K-FIRE 19 vs. CSR, BORAL & HEBEL
 using faster, simpler construction AS1530.4 NATA/CSIRO

BASED ON A 12m LONG 80m2 FIRE WALL GROUND LEVEL

Hebel 8 hrs x 2 men @\$65/hr	\$1040
CSR/Boral 8 hrs x 2 men @ \$65/hr	\$1040
FireCrunch 4 hrs x 2 men @ \$65/hr	\$520

1st FLOOR

Hebel 12 hrs x 2 men @\$65/hr	\$1560
CSR/Boral 10 hrs x 2 men @ \$65/hr	\$1300
FireCrunch 4 hrs x 2 men @ \$65/hr	\$520

TRUSS ZONE

Hebel 8 hrs x 2 men @\$65/hr	\$1040
CSR/Boral 6 hrs x 2 men @ \$65/hr	\$780
FireCrunch 4 hrs x 2 men @ \$65/hr	\$520

- ★ **No gantry hire required** with FireCrunch K-Fire 19 SL4
- ★ Hebel also requires mix-up of glue with water on site
- ★ CSR/Boral also has to fit an extra 16mm board at the floor bearers joints and truss zones

OVERALL LABOUR COMPARISON 80m2

Hebel	\$3640 = \$45.50/m2 plus gantry
CSR/Boral	\$3120 = \$39.00/m2 plus U track, H studs
FireCrunch	\$1560 = \$19.50/m2 - NO GANTRY, U TRACK OR H STUDS, MgSO4 CLADDING

COMPARISON BASED ON 80m2 SHAFT LINER DOUBLE STUD FRAME FIRE WALL TIMBER OR STEEL AS1530.4

Hebel	\$45.50/m2
CSR/Boral	\$39.00/m2
FireCrunch	\$19.50/m2