





## **PARTY WALL K-SOUND - FIRE 10mm**

**(Rw50) net ctr ,ACOUSTIC SYSTEM  
SINGLE FRAME FRL 60- 90 AND 120  
MINUTE FIRE AND ACOUSTIC WALL  
Rw50 LOAD AND NON LOAD  
BEARING**

FRL 60/60/60 timber TO FRL 90/90/90 Steel frame  
FRL 120/120/120 = 2 X10mm K CLAD each side of  
COLD ROLL FORMED STEEL FRAME (1 .15 BMT)

NATA Labs Australia Fire Tested Systems AS1530.4 a/ 2014 and more

[firecrunch.com.au](http://firecrunch.com.au)

-  **FIRE PROOF**
-  **FLOOD PROOF**
-  **IMPACT RESISTANT**
-  **TERMITE PROOF**
-  **MOULD & BACTERIA PROOF**



FIRE TESTED BY NATA / CSIRO & OTHERS

**NOTE:** FCA ref, is FireCrunch Australia

## FIXINGS PROCEDURES

### STEEL FRAME

USE SELF C/S 30 mm to 40 mm NEEDLE POINT ,WING  
TIP PLATED CORROSION PROOF SCREWS

### TIMBER FRAME

USE SELF C/S 30mm to 40mm needle point ribbed  
head bugle corrosion proof screws

Set screws at 200mm intervals on vertical set and 300  
mm on horizontal VIA NOGS ETC . SET SCREWS 15MM  
IN FROM EDGES

LEAVE 6 mm fire sealant gap between vertical set  
EXTERIOR SE10 CLAD sheets, backed with vertical stud facings use  
min 45mm width studs for adequate screw fixing spacing.  
USE AS 1530.4 SEALANT IN ALL GAPS

SEE MAIN FIRE MANUAL FOR FULL DETAILS

[https://firecrunch.com.au/wp-content/  
uploads/2023/11/M-01-FireCrunch-Fire-Manual.pdf](https://firecrunch.com.au/wp-content/uploads/2023/11/M-01-FireCrunch-Fire-Manual.pdf)

## INTERIOR =TE10 AND EXTERIOR = SE10 PLAIN SURFACE WALLS, EAVE S AND BOUNDARY WALL SYSTEMS

### K-Clad SE square edge

ORDER CODE FCA-SE10-2400 x 1200 ( 2700) OR (3000)

WALLS-INTERIOR -EXTERIOR-BOUNDARY-FIRE SEPARATION, EAVES ETC,  
EXTERIOR AND INTERNAL USES



Sizes: 2400 x 1200mm  
2700 x 1200mm  
3000 x 1200mm

### K-Clad Recessed Edge (TE)

ORDER CODE FCA-TE10-2400 x 1200 ( 2700) OR (3000)

TE 10 INTERIOR PLASTER SET



Sizes: 2400 x 1200mm  
2700 x 1200mm  
3000 x 1200mm

# PARTY WALL K-SOUND -FIRE 10 (Rw50) ACOUSTIC SYSTEM SINGLE FRAME

FRL...../60/60 = TIMBER frame FRL 90

## -120 STEEL Frame

FRL 60/60/60 timber TO FRL 90/90/90 Steel frame

**FRL /120/120 ADD 1 EXTRA 10mm sheet (2 EACH SIDE) to steel frame 1.15 BMT**

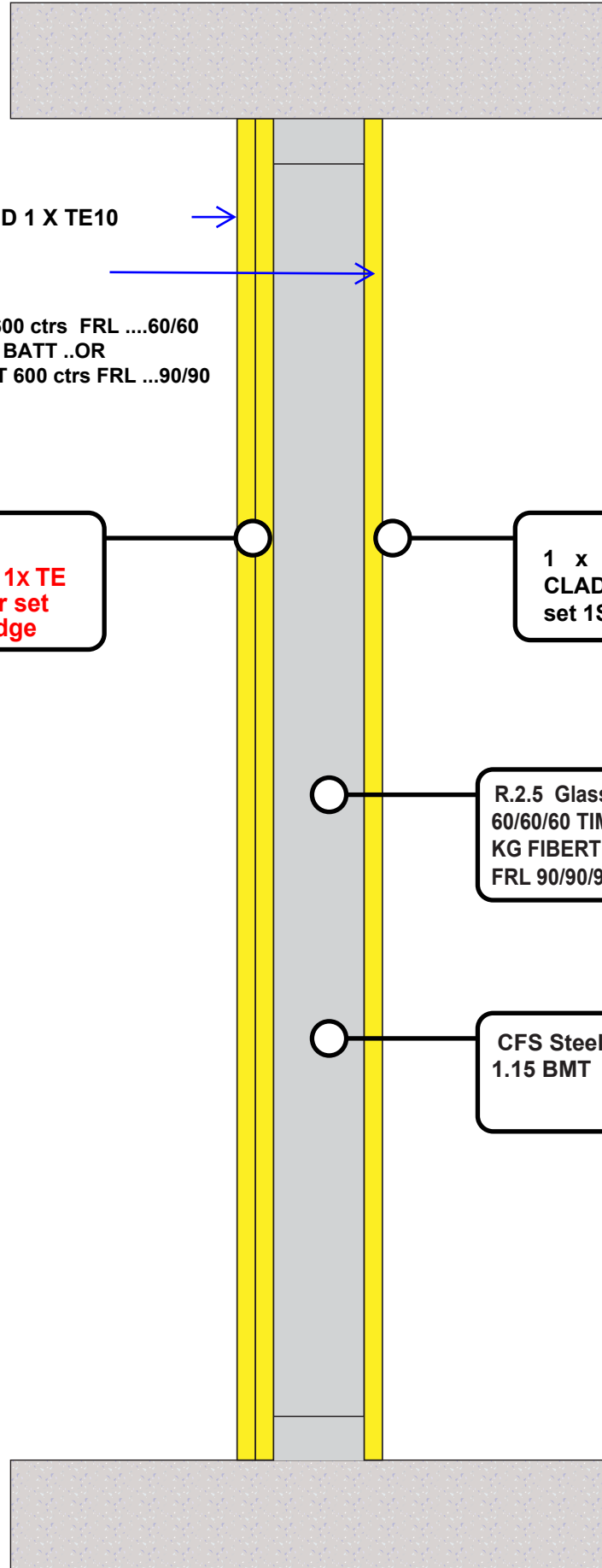

## WHAT YOU NEED

**SIDE 1 = 1 X K CLAD SE 10 AND 1 X TE10**

**SIDE 2 = 1 X K CLAD TE10**

90mm X 45mm timber stud frame 600 ctrs FRL ....60/60

R 2.5 90mm GLASSWOOL CAVITY BATT ..OR

92mm x 45mm steel frame 1.15BMT 600 ctrs FRL ...90/90

1x 90mm CSR FIBERTEX BATT

2 x 10mm sheets

1 x **SE10** inner and 1x **TE 10** outer, for plaster set joints --recessed edge

1 x 10mm sheet K CLAD **TE 10** for plaster set 1ST interior side

R.2.5 Glasswool BATT FRL 60/60/60 TIMBER 90mm AND 64 KG FIBERTEX 90mm FRL 90/90/90 STEEL 1.15 BMT

CFS Steel frame 90mm x 45mm 1.15 BMT

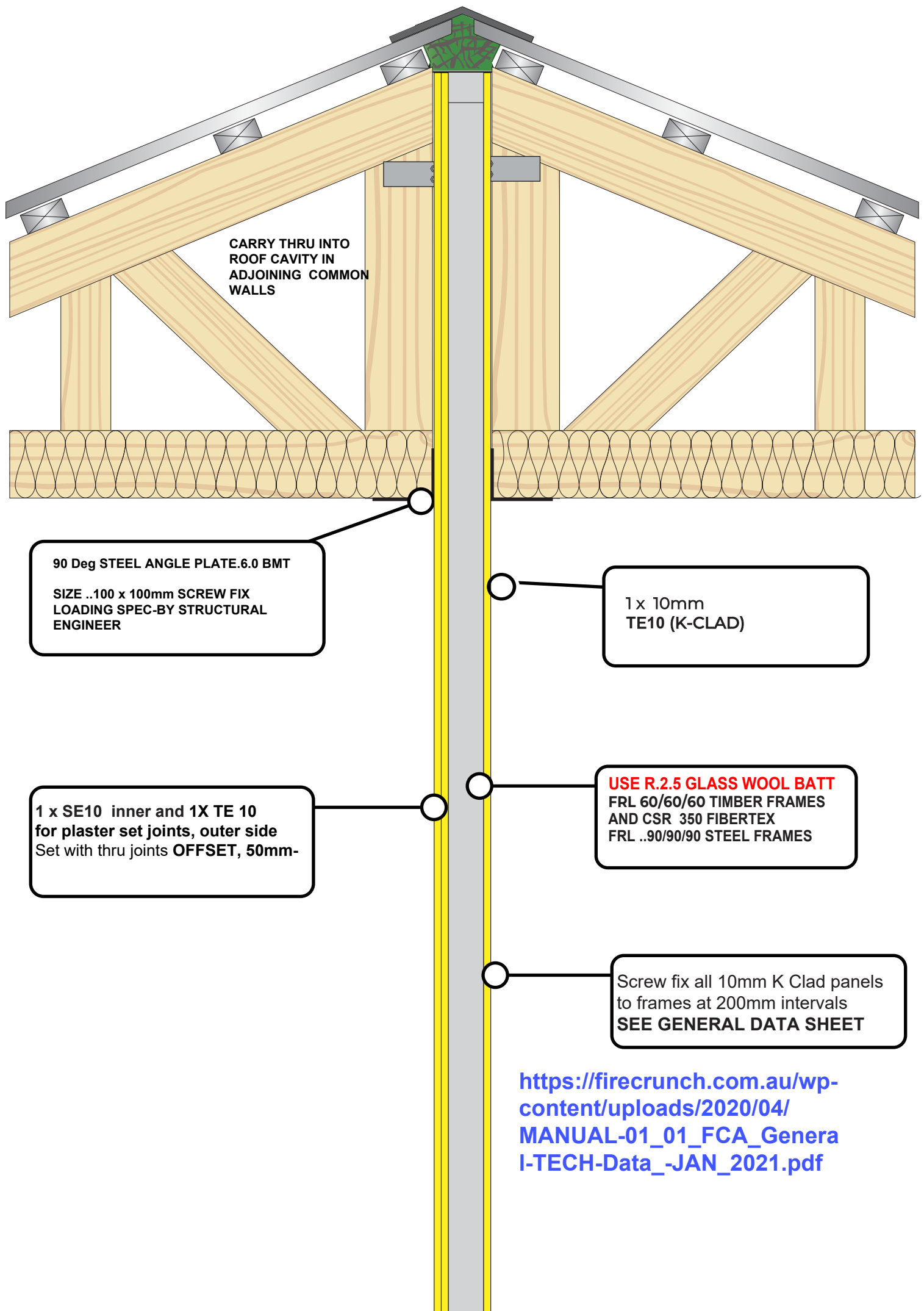

CARRY THRU INTO  
ROOF CAVITY IN  
ADJOINING COMMON  
WALLS

90 Deg STEEL ANGLE PLATE.6.0 BMT  
SIZE ..100 x 100mm SCREW FIX  
LOADING SPEC-BY STRUCTURAL  
ENGINEER

1 x 10mm  
TE10 (K-CLAD)

1 x SE10 inner and 1X TE 10  
for plaster set joints, outer side  
Set with thru joints **OFFSET**, 50mm-

**USE R.2.5 GLASS WOOL BATT**  
FRL 60/60/60 TIMBER FRAMES  
AND CSR 350 FIBERTEX  
FRL ..90/90/90 STEEL FRAMES

Screw fix all 10mm K Clad panels  
to frames at 200mm intervals  
**SEE GENERAL DATA SHEET**

[https://firecrunch.com.au/wp-content/uploads/2020/04/MANUAL-01\\_01\\_FCA\\_GeneraI-TECH-Data\\_-JAN\\_2021.pdf](https://firecrunch.com.au/wp-content/uploads/2020/04/MANUAL-01_01_FCA_GeneraI-TECH-Data_-JAN_2021.pdf)

## **CERTIFICATION AND TEST REPORTS**

<https://firecrunch.com.au/certifications/>

### **STEEL**

**NATA CSIRO FRL 60/60/60 AND 90/90/90  
ASSESSMENT OF TEST REPORT ,SINGLE STEEL  
STUD FRAME 90 X 45mm 1.15 BMT 64 KG 90mm  
GLASSWOOL BATT AS 1530.4 FIRE SEALANT**

### **STEEL**

**NATA LABS RESOLUTE QLD FRL ---/120/120  
TEST REPORT SINGLE STEEL STUD FRAME  
1.15 BMT 90mm X 45mm. R 2.5 90mm  
GLASSWOOL BATT. AS 1530.4 FIRE SEALANT**

### **TIMBER**

**NATA RESOLUTE LABS QLD TEST REPORT  
SINGLE TIMBER STUD FRAME RADIATA PINE  
90x 45mm  
*PLUS REGISTERED FE ASSESSMENT YGL FIRE  
ENGINEERS, SYDNEY. FRL 60/60/60***

**AS 1530.4 FIRE SEALANT-TRADES COUNTERS**

**FireCrunch Australasia Pty Ltd 37 620 875 041  
[support@firecrunch.com.au](mailto:support@firecrunch.com.au)  
1300 933 102  
NSW-QLD-VIC-ACT-SA-WA-NT-TAS**

