



## TECHNICAL SPECIFICATION DRAWINGS

PLAN DETAIL - JUNCTION OF  
STAGGERED MASONRY VENEER  
WALL TO DOUBLE STUD FIRE WALL  
(90x 45mm Timber Stud frame )  
(1.15 BMT Steel Frame)

# FRL 90/90/90

NATA Labs Australia Fire Tested Systems **AS1530.4** and more

**NOTE:** FCA ref, is FireCrunch Australia



[firecrunch.com.au](http://firecrunch.com.au)



# 04

## FRL 90/90/90

(90x 45mm Timber Stud frame )  
or (1.15 BMT Steel Frame)

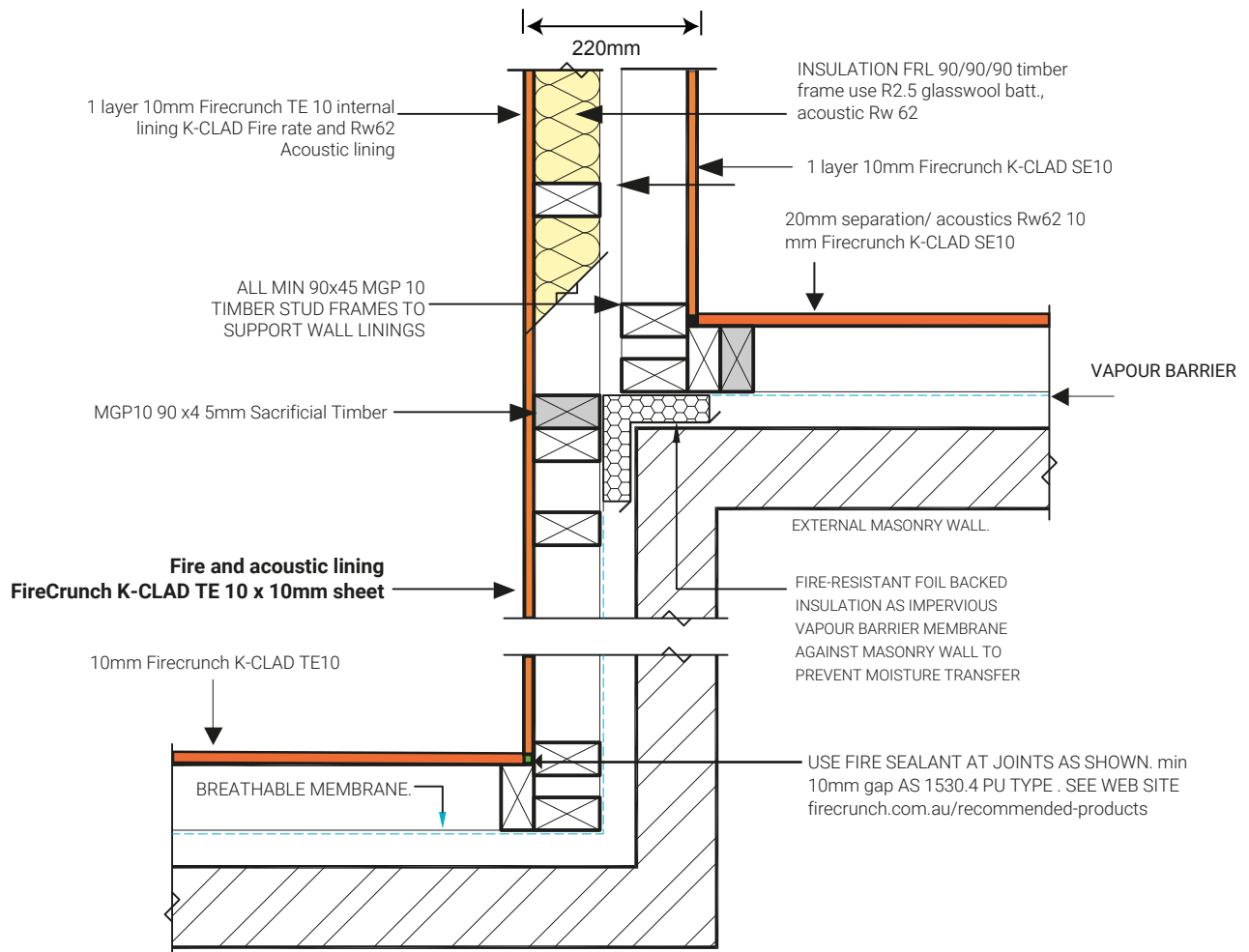

**Summary:** All FireCrunch drawings are generic and not to scale, builders should read the manuals for each type of construction and use the recommended products listed on the home page browser web site. Specific Plaster set products listed are related to warranty in plaster setting joints, fixings can be any brand, to the specs listed in the general technical manual, as are insulation batts, fire sealants, etc. These are all available from trades hardware suppliers in Australia. The vapour permeable primer sealer is a warranty brand and type product and must be used on the fca boards first, once sealed, any brand of water based finishing top paints may be used for interior or exterior finishing. Do not use regular undercoat primers on any FireCrunch (FCA) mgso4 boards, as it will void the warranty.