

## FireCrunch protects from Bushfires to Hi rise and Residential,

Call Firecrunch TODAY **1300 933 102**

FireCrunch (K CLAD) AS1530.4 ..PLUS

Acoustic Rw 62 plus ctr 52 AS/717

NATA Labs Non chloride, Non asbestos tests, AS 4964 FRL

30/30/30 to 90/90/90 -SINGLE LAYER 10mm FireCrunch

(NATA Fire Test) Certificates

BAL FZ AND AS1530.8.2 AS 3959 NCC 2019 (APS)



**FRL 90/90/90 = 1 x 10mm sheet per side**

**FRL 120/120/120 = 2 x 10mm sheet per side**

Fire resistance is measured to fire testing standards set by the BCA  
( Building Code of Australia) Known as FRL ( Fire Resistant Level )

**NOTE:** FCA ref, is FireCrunch Australia



[firecrunch.com.au](http://firecrunch.com.au)





Slab BASE Fixing method

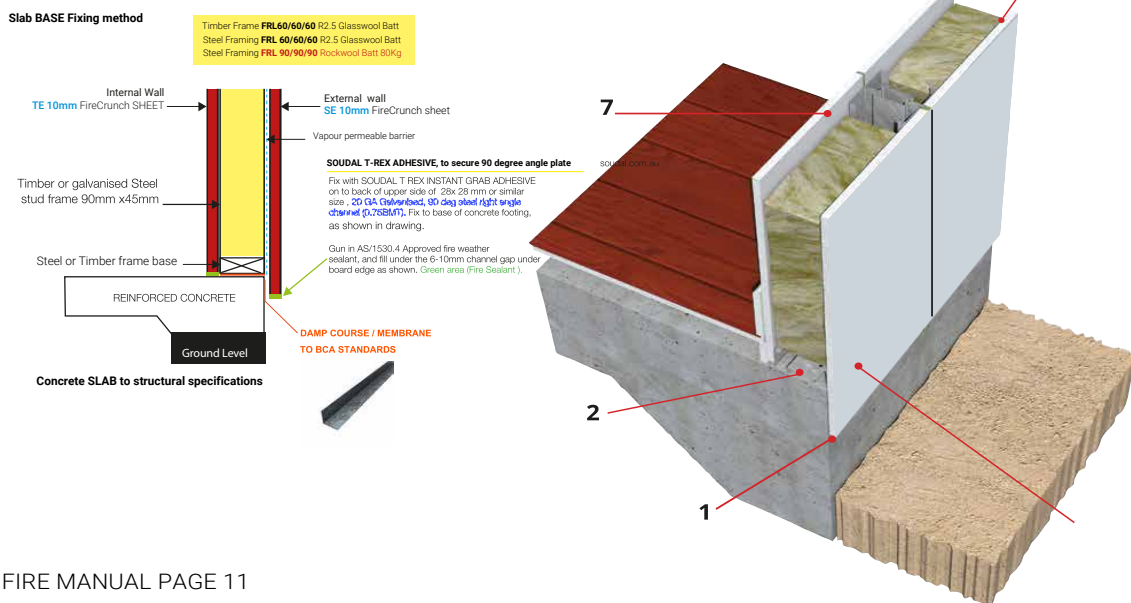

FIRE MANUAL PAGE 11



Load bearing test  
5 tonne ,55kN

FireCrunch MgO  
10mm 3m x 1.2m  
Product sheets  
both sides of frame

3mx3m Test  
furnace ,1000  
deg c, closes  
up to within  
150mm of test  
specimen for 90  
minutes

High pressure gas burners

**CSIRO FIRE TESTING  
CENTRE NORTH RYDE NSW**



Tests are rated in "load bearing" which are shown in three figures ,and tests in Non load bearing shown as 2 figures. IE

**FRL ( Fire Resistance Level) Load bearing  
FRL 60/60/60 or Non load bearing FRL ..../60/60**

What do these figures mean

(1st) 60 minutes of structural adequacy

(2nd) 60 minutes of material integrity

(3rd) 60 minutes of insulation & temperature

The test needs to demonstrate that the unexposed side of the fire wall facing into the next door apartment will not exceed a temperature of 140 deg c average plus ambient. or 180 deg c any point .FRL 90/90/90 FireCrunch's fire tested capability varies with density of fire batt insulation used and the following are the CSIRO Tested and other Assessed formulas .

Higher density are more expensive so FireCrunch allows you to set the batt cost to the FRL required .

R2.5 GLASSWOOL BATT ask us).

Bush fire to BAL FZ (low requirement for FireCrunch)  
FRL 30/30/30 10mm FireCrunch each side of frame plus R 2.5 GLASSWOOL batt Boundary walls and some fire separation walls FRL 60/60/60 10mm FireCrunch each side of frame plus R 2.5 GLASSWOOL batt Higher FRL requirements in hi rise Residential buildings etc.

FRL 90/90/60 10mm FireCrunch each side of frame plus ROCKWOOL batt MIN 75Kg

FRL90/90/90 10mm FireCrunch each side of frame plus

FRL 120/120/120 DTS/NCC

Acoustics (Rw) and Fire (FRL) are the two important essentials in fire separation walls. Acoustics with FireCrunch 10mm will perform at a minimum of Rw 62 plus ctr,52 using minimum R 2.5 fire insulation batts in discontinuous double stud steel frame fire separation walls.Ask for NATA LABS CSIRO test certificates.

**NOTE: UNDER THE BCA AN FRL CAN ONLY BE QUALIFIED WITH CLADDING BOTH SIDES OF THE SUPPORT FRAME, PROVING THE UNEXPOSED FACE DOES NOT EXCEED 140 Deg c AVERAGE ,OR 180 Deg c AT ANY ONE POINT FOR THE TEST DURATION AT 1000 Deg c**

FIRECRUNCH ARBN IS A REGISTERED  
A BUSINESS NAME AND THE COMPANY IS REGISTERED WITH THE AUSTRALIAN SECURITIES AND INVESTMENTS COMMISSION CANBERRA ACT. (2016) UNDER THE CORPORATIONS LAW

CALL TODAY **1300 933 102**

[sales@firecrunch.com.au](mailto:sales@firecrunch.com.au)



[firecrunch.com.au](http://firecrunch.com.au)

